

# PNEUMATIC LEAD SCREW TAPPING UNIT LS 22

The LS 22 consists of a vane motor powered by compressed air, a planetary gearbox, lead screw, nut and a follower with cams to activate built-in switches. The design of the LS 22 is compact yet highly functional. The lead screw ensures high repeatability for threading operations.

- EXTREMELY COMPACT DESIGN
- SEALED LEAD SCREW
- LOW NOISE LEVEL
- SMART DEPTH CONTROL
- AVAILABLE IN ALL THREAD TYPES AS WELL AS LEFT HAND



## Guidlines for choice of unit

[M-Thread]

TAPPING UNIT	CAPACITY IN STEEL				CAPACITY IN ALUMINIUM/BRASS				CAPACITY IN PLASTICS				
	No of Spindles	1	2	3	4	1	2	3	4	1	2	3	4
LS 223	M8	M6	M6	M5	M12	M10	M8	M8	M12	M12	M10	M10	
LS 225	M6	M5	M5	M4	M12	M8	M6	M6	M12	M10	M8	M8	
LS 226	M6	M5	M5	M4	M10	M8	M6	M6	M10	M8	M8	M6	
LS 2213	M5	M4	M4	M3	M8	M6	M5	M5	M8	M8	M6	M5	
LS 2221	M4	M3	M3	M2	M6	M5	M4	M4	M8	M6	M5	M4	
LS 2228	M3	M3	M2		M5	M4	M3	M3	M6	M5	M4	M4	

## Performance specifications at 6.3 Bar

Power	0.16 kW	Depth accuracy +/-	0.01 mm
Stroke (max, 100% controlled)	51 mm	Working pressure range	6–7 Bar
Min. Center to Center Spacing		Air consumption	<0.3 Nm <sup>3</sup> /min
Single Spindle	42 mm	Sound level	70 dB(A)
Double-Spindle Head	11 mm		

TAPPING UNIT	SPEED (IDLE) [RPM]	SPEED (AT MAX OUTPUT) [RPM]	TORQUE (AT MIN STARTING) [NM]	TORQUE (AT MAX OUTPUT) [NM]
LS 223	240	140	13.4	10.8
LS 225	400	240	8.0	6.7
LS 226	540	310	5.9	5.0
LS 2213	1 050	650	3.0	2.4
LS 2221	1 750	1 050	1.8	1.5
LS 2228	2 400	1 390	1.3	1.1

**Dimensions** [mm]

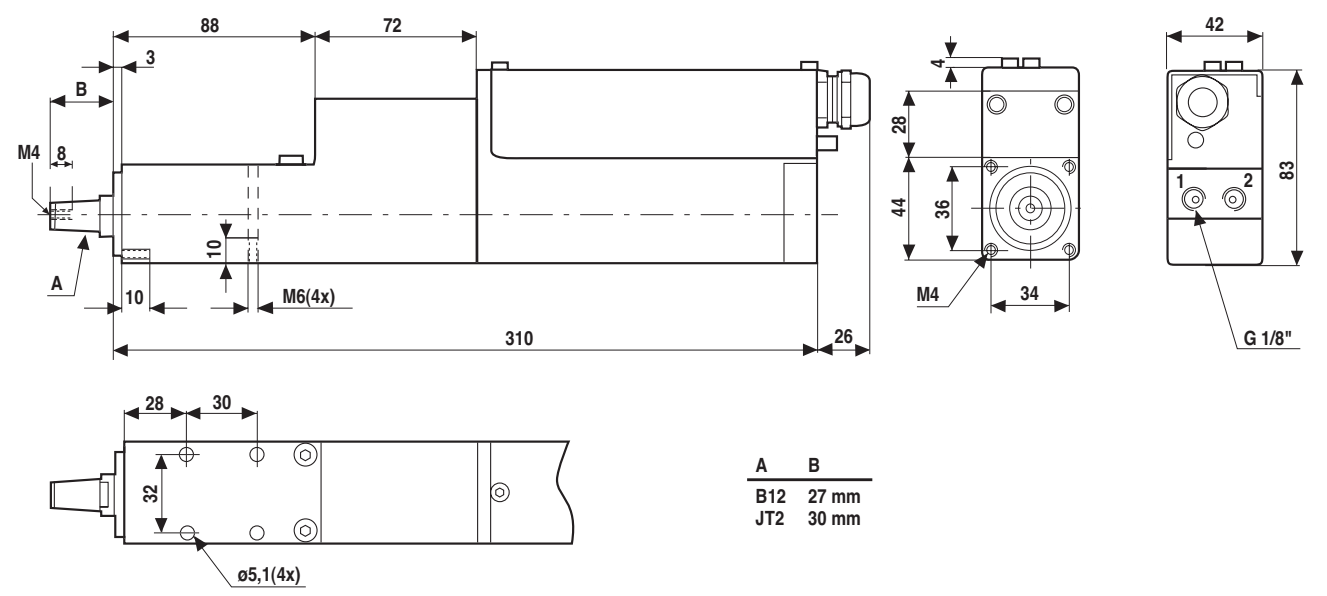

You can download 2D CAD-drawings and 3D CAD-models on [www.e2systems.com](http://www.e2systems.com).

**WEIGHT 4.6 KG**

**Necessary components**

QUICK CHANGE CHUCKS	TYPE	PAGE
	WFO for B12 Metric	52
	C12 for JT2	52
TAP HOLDERS	TYPE	PAGE
	SE0/WE0 for WFO/B12 Metric	52
	T12 for C12 (JT2)	52
LIMIT SWITCHES	TYPE	PAGE
	Electric Pneumatic	58

**Accessories**

MULTI-SPINDLE HEADS	TYPE	PAGE
	Adjustable heads VH04-, MBKV 402 and MBK 6V2-series	42 48
CONTROLS	TYPE	PAGE
	Controls for LS 11/22-units  Electric Pneumatic	58
MOUNTINGS	TYPE	PAGE
	Mountings for the LS22 units.	

On [www.e2system.com](http://www.e2system.com) you can find more information as well as the same information as above in imperial units.  
 When requesting a quote or ordering, please state: **Model, Limit switches, Ø and □** for the tap holder, pitch, and if it is to be used in Lubrication-free operation.