

# CUTTING TOOLS

**BAHCO**  
DORTMUND

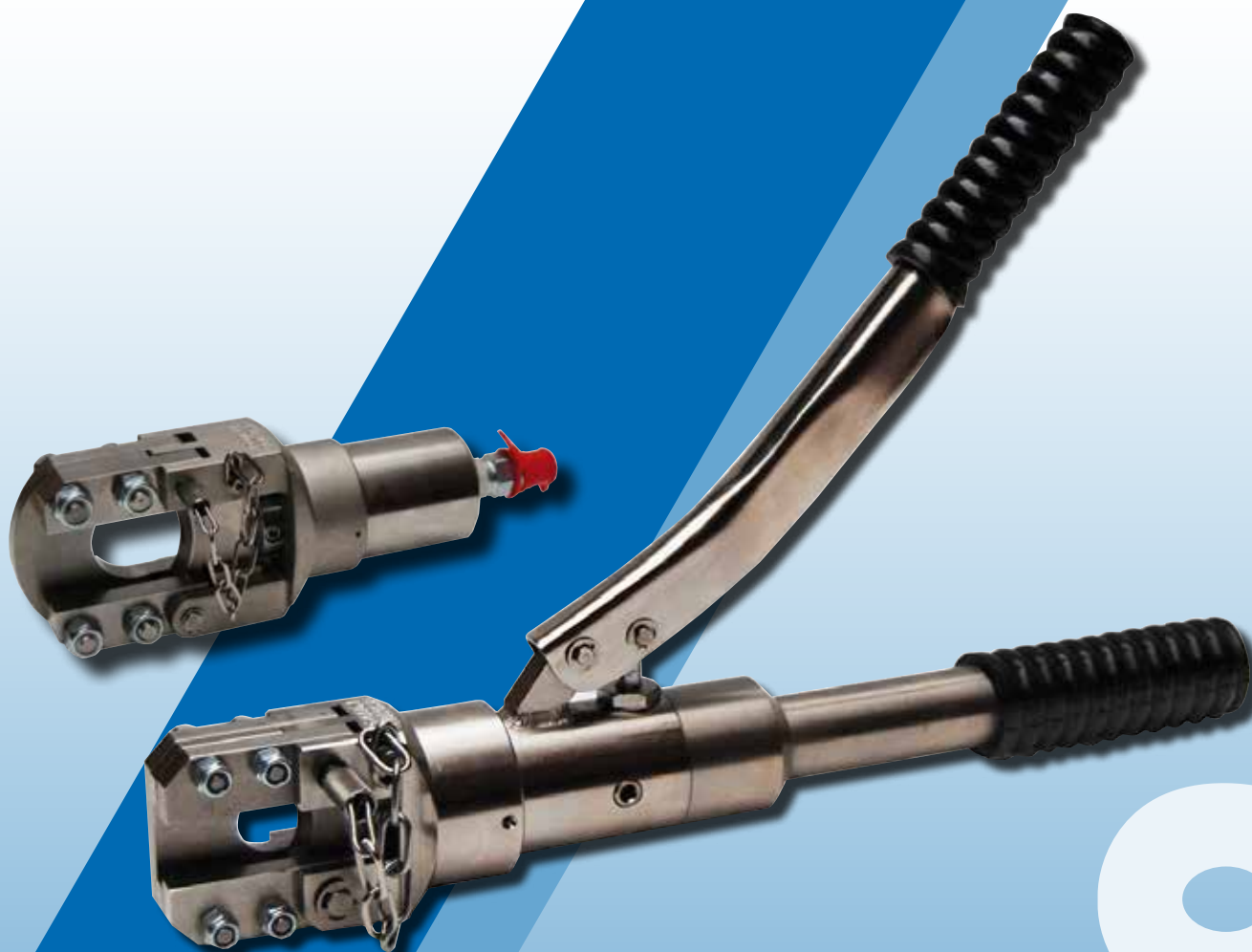

**WIRE ROPE AND CABLE  
CUTTERS SERIES CC**

**BAHCO**



## BAHCO GmbH & Co.KG

Martener Hellweg 60

DE- 44379 Dortmund

### Phone

+49 231/91 72 11-0

### Fax

+49 231/91 72 11-22

www.bahco.de

info@bahco.de

## Dimensions

Type	Cap. kN	L mm	C mm	Weight Kgs	Wire cable		Cable			Steel cable		Rod			
					Alum. with Copper	Alum. with Cop-per	Phone	with lead cover.	undergr.	max.hardness 1.800 N/mm <sup>2</sup>		Breaking point 400 N/mm <sup>2</sup>			
					Ø outs. mm	Ø outs. mm	Ø outs. mm	Ø outs. mm	Ø outs. mm	Ø Wire mm	Steel	Alloy Copper	Alloy Alum.		
CC.00.18	50	385	18	2.8	18	18	18	18	18	18	1	12	15	15	
CC.01.18 *	50	212	18	2	18	18	18	18	18	18	1	12	15	15	
CC.00.40	140	490	41.5	5.6	40	40	40	40	40	40	32	2	20	30	30
CC.01.40 *	135	290	41.5	4.5	40	40	40	40	40	40	32	2	20	30	30
CC.00.75	70	650	75	6.8	40	*	75	75	75	75	*	*	*	*	*
CC.01.75 *	70	451	75	5.5	40	*	75	75	75	75	*	*	*	*	*
CC.01.90	110	535	90	9.4	35	*	90	90	90	90	*	*	*	*	*
CC.01.120 *	135	630	122	11.7	35	*	120	120	120	120	*	*	*	*	*
CC.01.60 *	437	380	60	12	60	60	60	60	60	60	60	3	25	35	35
CC.02.60 •	390	490	60	12	60	60	60	60	60	60	60	3	25	35	35

- Double-acting version
- \* is operated with an external pump

\* The device is not designed for cutting this class or this type of material. Any attempt to cut this material can result in injury or damage on the device and leads to the loss of the guarantee. Operating pressure 700 bar.

## Technical drawing

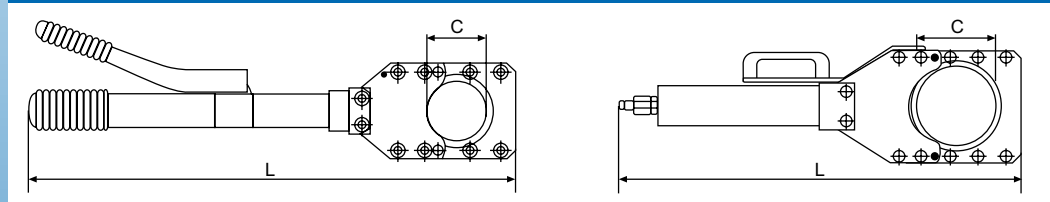

## Replacment blades

for Type	Part Number
CC.00.18	CRC.18
CC.01.18	CRC.18
CC.00.40	CRC.35-40
CC.01.40	CRC.35-40
CC.00.75	CRC.70
CC.01.75	CRC.75
CC.01.90	CRC.01.90
CC.01.120	CRC.01.120
CC.01.60	CRC.01.60
CC.02.60	CRC.01.60

All information subject to change without further notice.  
No responsibility is taken for the correctness of the named specifications.