

# 800 bar

**BAHCO**  
DORTMUND



## **STAINLESS STEEL PUSH CYLINDER SERIES CRB / 13 - 100 TONES**

Cylinder of the CRB Series are based on the proven CX / CR series. The cylinders withstand without damage a eccentric load. Due to the very sturdy construction, an insert is also possible under the most adverse conditions.

- 25-200 mm stroke
- Stainless steel cylinder
- single acting with spring return
- Operating pressure 800 bar

# BAHCO



**BAHCO GmbH & Co.KG**

Martener Hellweg 60

DE- 44379 Dortmund

**Phone**

+49 231/91 72 11-0

**Fax**

+49 231/91 72 11-22

www.bahco.de

info@bahco.de

**Technical drawing**

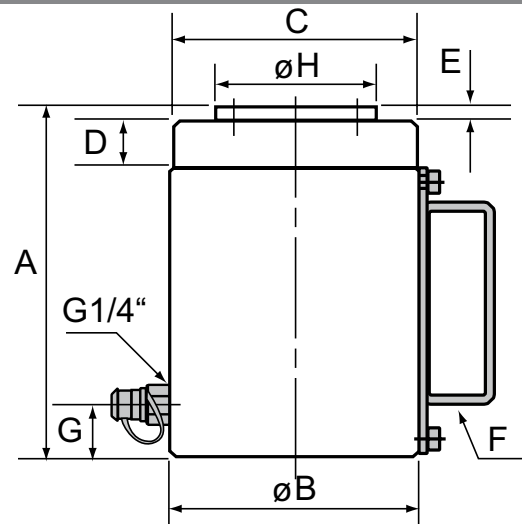

**Dimensions**

Type	Work.- press. MPa	Capa- city t/kN	Stroke- length mm	Oil- vol. cm <sup>3</sup>	Piston area cm <sup>2</sup>	Length A mm	Dia- meter B mm	C mm	D mm	E mm	F Hand.	G mm	H mm	Weight kgs
CRB 13-50	80	13/127	50	80	15.9	134	58	M58x2	25	6		20	38	2.3
CRB 13-100	80	13/127	100	159	15.9	184	58	M58x2	25	6		20	38	3.0
CRB 13-150	80	13/127	150	238	15.9	234	58	M58x2	25	6		20	38	3.7
CRB 25-25	80	25.4/249	25	78	31.2	115	80	M80x3	30	7		20	55	3.7
CRB 25-50	80	25.4/249	50	156	31.2	140	80	M80x3	30	7		20	55	4.4
CRB 25-100	80	25.4/249	100	312	31.2	190	80	M80x3	30	7		20	55	5.9
CRB 25-150	80	25.4/249	150	468	31.2	240	80	M80x3	30	7		20	55	7.3
CRB 25-200	80	25.4/249	200	624	31.2	290	80	M80x3	30	7		20	55	8.7
CRB 40-50	80	41/402	50	251	50.3	146	105	M105x3	25	7	W	20	70	8.5
CRB 40-100	80	41/402	100	502	50.3	196	105	M105x3	25	7	W	20	70	11.0
CRB 40-200	80	41/402	200	1005	50.3	296	105	M105x3	25	7	W	20	70	15.6
CRB 63-50	80	64/628	50	393	78.5	160	130	M130x3	25	7	W	32	80	14.0
CRB 63-100	80	64/628	100	785	78.5	210	130	M130x3	25	7	W	32	80	17.7
CRB 63-200	80	64/628	200	1571	78.5	310	130	M130x3	25	7	W	32	80	24.9
CRB 100-50	80	100/982	50	614	122.7	183	160	M160x3	30	9	W	35	100	23.7
CRB 100-100	80	100/982	100	1227	122.7	233	160	M160x3	30	9	W	35	100	28.9
CRB 100-200	80	100/982	200	2454	122.7	333	160	M160x3	30	9	W	35	100	39.3

Connection thread for quick coupling G1/4"

- CRB 40, 63 and 100 - inclusive handle.
- Nipple not included. Please order separately.

• Mechanical locking for CRB-Series see Hydraulic accessories.

All information subject to change without further notice.  
No responsibility is taken for the correctness of the named specifications.