

HYDRAULIC - PUSH CYLINDER - TYPE: CF240/CF240P

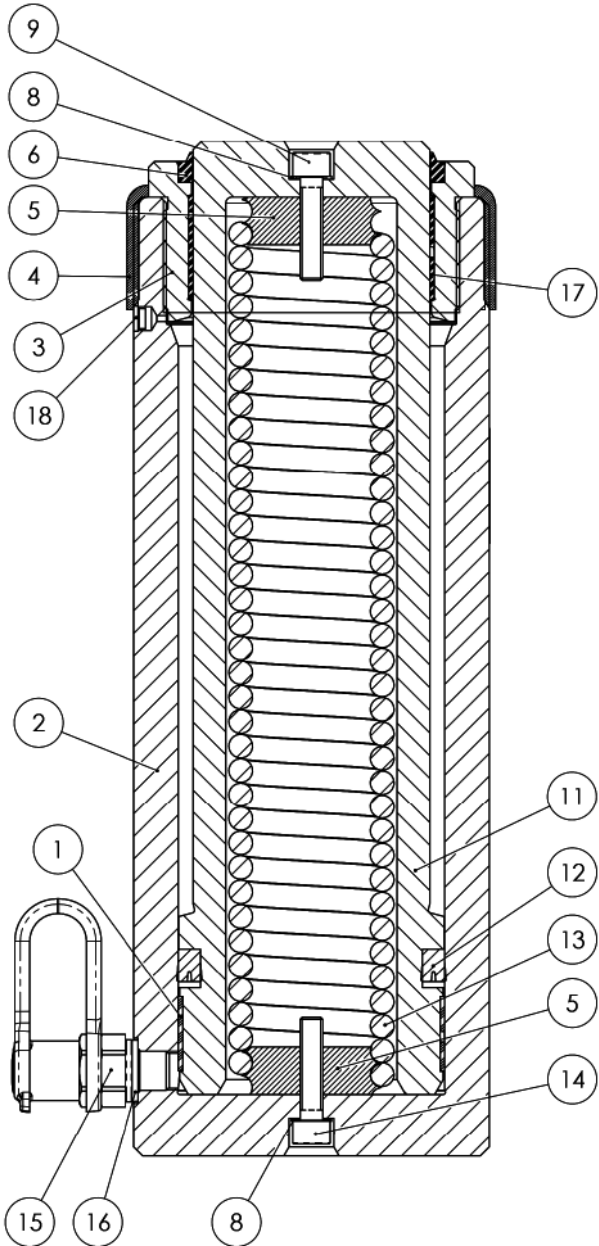

Pos.	Qty	Description	Part-No.
1	1	Piston guide	*
2	1	Cylinder	35070
3	1	Bushing	25074
4	1	Protection ring	20580
5	2	Spring attachment	**
6	1	Packing	*
8	2	Packing	*
9	2	Screw	25123
11	1	Piston	25089
12	1	Packing	*
13	1	Spring	**
15	1	Coupling nipple TX23S (optional)	38815500
15P	1	Coupling AQI 24 (optional)	38403860
16	1	Packing	*
17	1	Packing	*
18	1	Filter	17625
		* Seal kit	19217
		** Spring kit cpl. CF240	20566
		* Only available in Seal kit	
		** Only available in Spring kit cpl.	

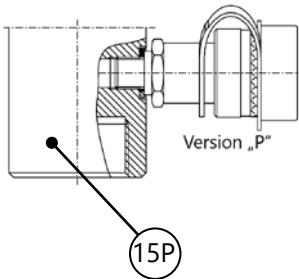

Documentation commissioner:
Andreas Bos
Version: 02.2023

BAHCO GmbH & Co. KG
Martener Hellweg 60
44379 Dortmund
Phone: +49(0)231 91 72 11-0
Fax: +49(0)231 91 72 11-20
Internet: www.bahco.de
E-Mail: info@bahco.de

Hydraulic Push Cylinder Spare Part List

Type
CF240/CF240P

BAHCO
DORTMUND