

700 & 800 BAR

BAHCO
DORTMUND



**HYDRAULIC SPREADER WITH
SPRING RETURN**

Spreading force 0.9 tons up to 5 tons

BAHCO

The single-acting spreaders have a built-in pressure cylinder and a movable „jaw“ with spring return. The HS types are directly coupled to a hand pump and can be used in any position. In contrast, the ESH 10 and CS types are connected to an external pump (see page 3) via a pressure hose.

The spreaders offer a wide variety of applications. Whether for scrapping or demolition work in rescue or disaster service, industry, and many other fields the spreaders fulfill their service wherever something has to be lifed or spreaded.

- 5 models, 80 to 120 mm Spreading width
- Spreader without pump (ESH 10; CS)
- spreader with pump (HS)
- With spring return (ESH, CS, HS)
- Corrosion protected
- Good weight / capacity ratio
- Slip-proof spreading surfaces

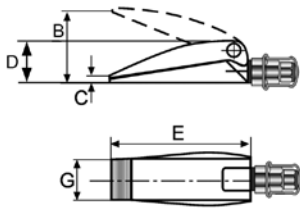

Dimensions

Description	Order No.	Capacity kN at 700 bar			Spreading size mm	Displacement cm ³	Spreading class tn	Weight kg
		Top	at P	Pull				
ESH 10	38014507	9	-	spring	85	11	1	1.8

Description	A mm	B mm	C mm	D mm	E mm	G mm	Remark
ESH 10	-	85	8	53	168	46	only spreader, max. 700 bar

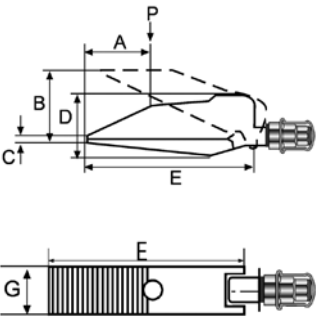

Description	Order No.	Capacity kN at 700 bar			Spreading size mm	Displacement cm ³	Spreading class tn	Weight kg
		Top	at P	Pull				
CS 20-120	38361800	20	44	Spring	120	30	2	5.4
CS 50-120	38361900	50	110	Spring	120	66	5	15.0

Description	A mm	B mm	C mm	D mm	E mm	G mm	Remark
CS 20-120	98	120	9	90	240	66	only spreader, max. 800 bar
CS 50-120	150	132	12	102	305	110	only spreader, max. 800 bar

Dimensions										
Description	Order No.	Capacity kN at 700 bar			Spreading size mm	Displacement cm ³	max. Pump force N	Numbers of pump stroke	Spreading class tn	Weight kg
		Top	at P	Pull						
HS 20-120	37284	20	44	Spring	120	30	300	25	2	8.8
HS 50-120	38911900	50	110	Spring	120	66	300	55	5	18.0

Description	A mm	B mm	C mm	D mm	E mm	F mm	G mm	H mm	Remark
HS 20-120	98	120	9	90	240	120	66	700	with attached hand pump P15-8, max. 800 bar
HS 50-120	150	132	12	102	305	120	110	730	with attached hand pump P15-8, max. 800 bar

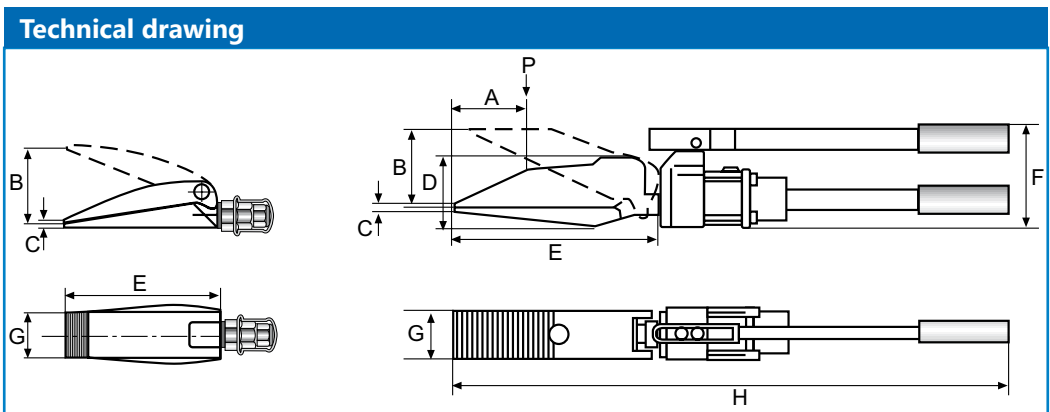

For type ESH, please order the pump with max. 700 bar operating pressure!
The spreaders can be connected to the following pumps:



BAHCO
DORTMUND



BAHCO GmbH & Co.KG

Martener Hellweg 60

DE- 44379 Dortmund

Phone

+49 231/91 72 11-0

Fax

+49 231/91 72 11-22

www.bahco.de

info@bahco.de

BAHCO

All information subject to change without further notice.
No responsibility is taken for the correctness of the named specifications.